

BB-2 SS

Stainless Steel

**Industrial
Case Taping System**

User Guide

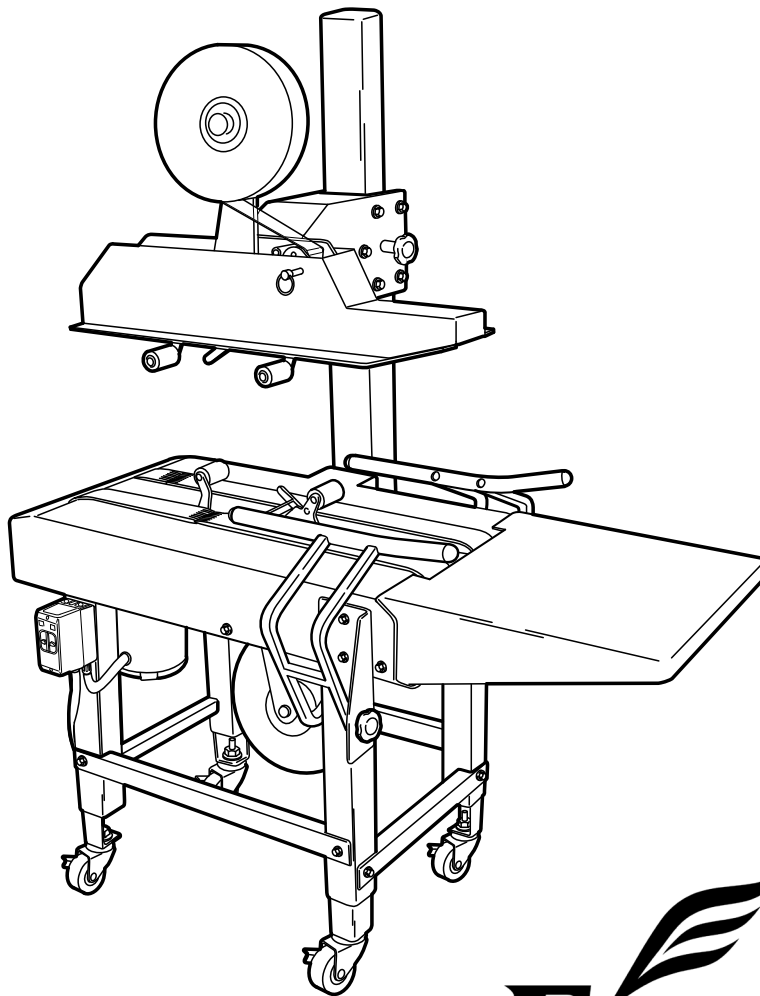

EASTEY[®]

BB-2 SS Stainless Steel

Industrial Case Taping System

User Guide

Revised 11/12/2018

P/N 5000798 Rev. A

Copyright and Trademarks

Copyright ©2018 Engage Technologies Corporation
All rights reserved. All trademarks and brand names
are the property of their respective owners.

Eastey
7041 Boone Ave N.
Brooklyn Park, MN 55428

Phone: (763) 428-4846; Fax: (763) 795-8867; Toll Free: 1-800-835-9344
www.eastey.com

Contents

- Safety 7**
- Introduction 8**
 - BB-2 SS Overview 8
 - Specifications 9
- Installation and Setup 10**
 - Removing the Shipping Pallet 10
 - Installing the Optional Locking Casters 11
 - Set Machine Height 12
 - Location Requirements 12
 - Loading the Tape Cartridges 13
- Operation 19**
- Adjustments 20**
 - Package Width 20
 - Package Height 20
- Maintenance 21**
 - Rollers 21
 - Cutting Knives 21
 - Changing Drive Belts 22
- Troubleshooting 25**
- Parts List 27**
 - Main Assembly 27
 - Electrical / Drive Motor 28
 - Infeed / Idler Rollers 29
 - Carton Guides with Width Adjustment 30
 - Upper Head Bracket Bearings 31
 - Upper Head Bracket and Height Locking Knob 32
 - Upper Head Constant Force Spring Assembly 33
- Warranty Statement 34**
- Customer Support 36**

Safety

Safety Precautions

Before installing, operating or servicing this equipment, please read the following precautions carefully:

- This machine is equipped with moving belts. Do not place hands near the belts when they are moving as fingers may be pinched where belts enter the frame. We suggest the use of a roller-type exit conveyor or pack table for your cases. Always remove boxes after they clear the exit end of the machine.
- Observe caution when near the tape heads or when threading tape. The tape cutting knives are very sharp, automatically operated, and linked to tape wipe down rollers.
- Always disconnect electrical power before attempting maintenance for any electrical or moving parts. Do not attempt to open or work on the electrical box, junction boxes, or other electrical components of the unit without first disconnecting power to the machine. Electrical shock hazard exists if power is not disconnected.
- Use only the specified power-supply cable. Do not use the power cable to pull or position the machine, as this will damage or break the cable.
- Do not by-pass any factory-designed safety features such as guards, interlocks, switches, etc. Do not operate the machine if such modifications have been made.
- Do not attempt to operate the machine with loads that exceed the limits of use and operation in regards to weight and sizes, or with unstable loads that present a hazard of tipping or falling.
- This equipment is designed for indoor operation in a typical clean, dry factory environment. Do not operate the machine in any extremely wet or oily environment that may exceed operating specifications.
- Do not place hands, head, or any part of the body inside the confines of the machine unless the tape head mechanisms are securely fastened, and the electrical supply is shut off.
- To minimize the potential for personal injury, always be sure that the machine operators and others working on the machinery are properly trained in the correct usage of the equipment and properly instructed regarding safe operation.
- Never provide service or clear a box jam when machine is running. Always stop the machine and shut off power before servicing.
- When feeding a box into the unit, always hold down the box top and present the box to unit. Release hands as soon as the belts begin to take the box.
- Do not wear loose clothing such as ties, scarves, jewelry etc. Long hair should be pulled back and/or covered while operating this machine.

Introduction

BB-2 SS Overview

The belt driven BB-2 SS is a stainless steel case taper that is designed to tape the tops and bottoms of uniform sized boxes at rates determined by the operator.

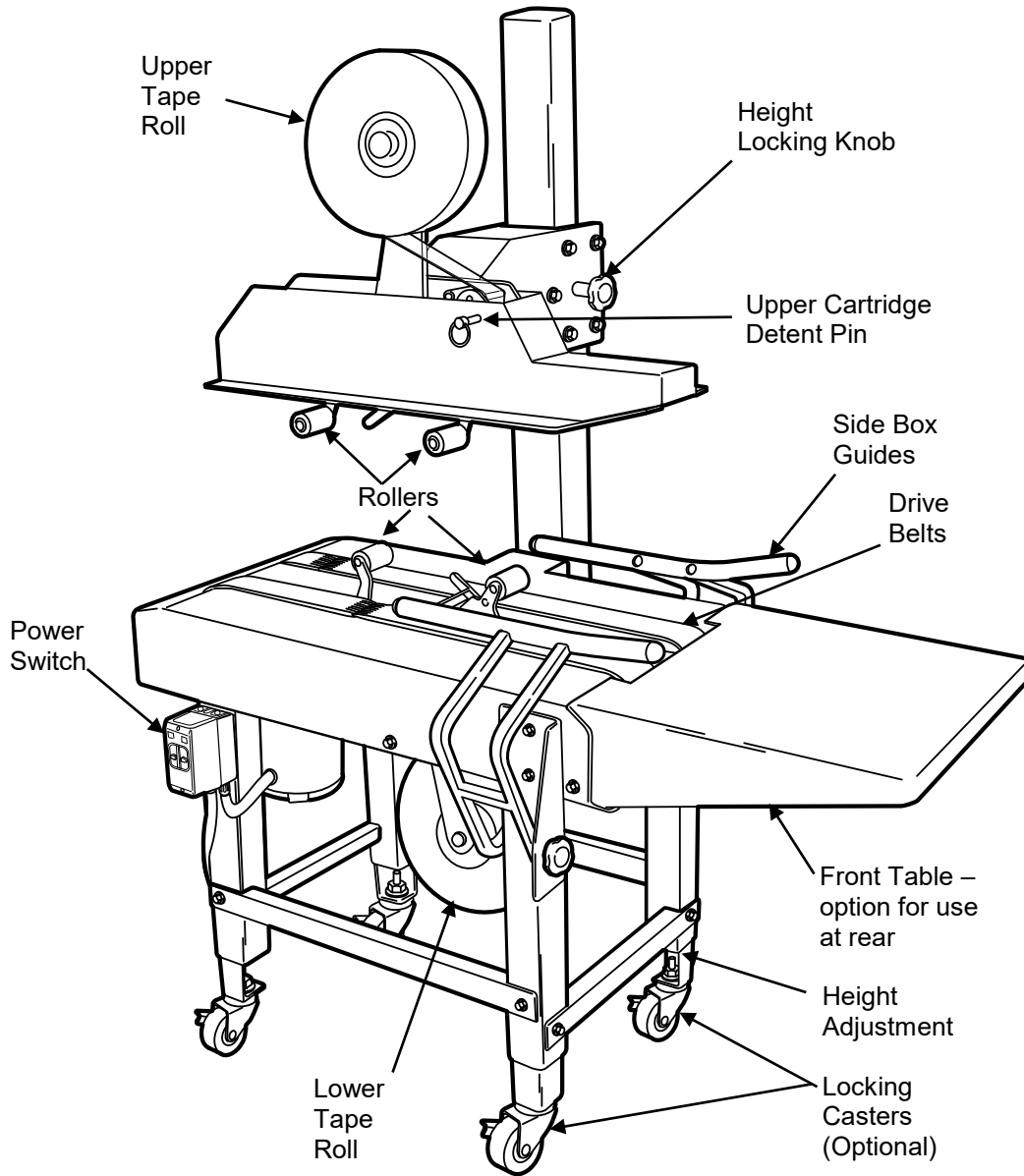

Specifications

Model	BB-2 SS
Tape	1.5 inches (3.6 cm) or 2 inches (5 cm), up to 15 inches (36 cm) diameter rolls
Machine size	Width (A) 31.54 inches (80 cm) Height (B) Min. 57.25 inches (145.4 cm) Height (B) Max. 65.25 inches (165.7 cm) Length (C) Min. 31.19 inches (79.2 cm) without packing table Length (C) Max. 47.44 inches (120.5 cm) with packing table

Dimensions

Dimensions shown in inches.

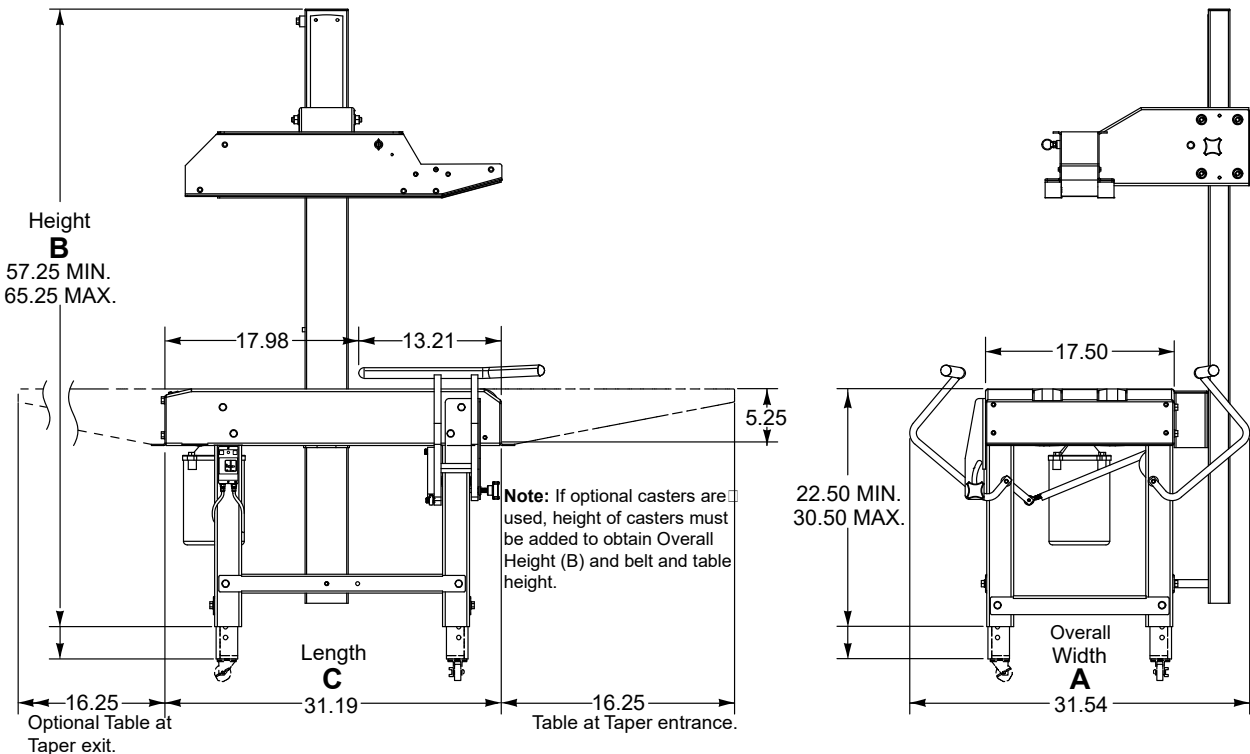

Options

- 16.25 inch (41.27 cm) packing/exit table
- Set of four locking casters
- Top squeezers

Installation and Setup

Open the box and remove shipping materials carefully to avoid damaging the machine body.

CAUTION! The BB-2 SS Case Taper is very heavy and will require a forklift, floor crane, or several people to move it safely off the shipping pallet. Use proper equipment when lifting the case taper and ensure the case taper is secure and will not shift while the shipping pallet is being removed or during height adjustment or optional caster installation.

Removing the Shipping Pallet

Undo the four shipping bolts that secure the BB-2 SS to the shipping pallet and lift the BB-2 SS Case Taping System from the pallet.

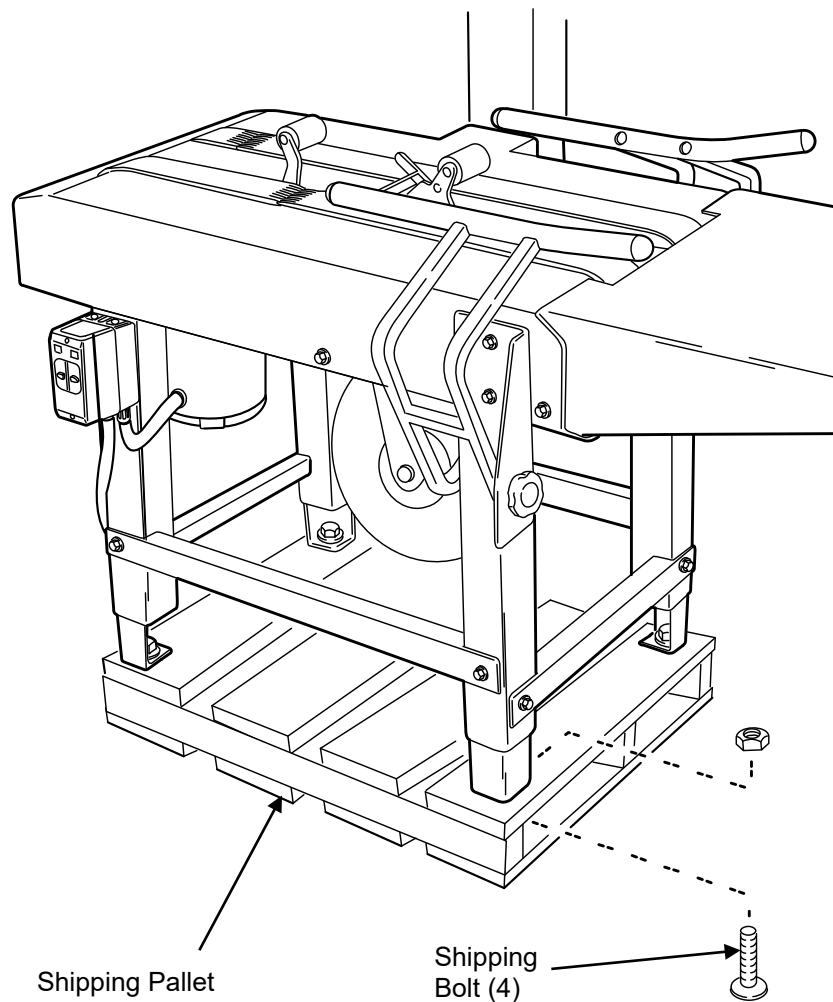

Installing the Optional Locking Casters

If you have purchased the optional locking casters install them on the four taper legs.

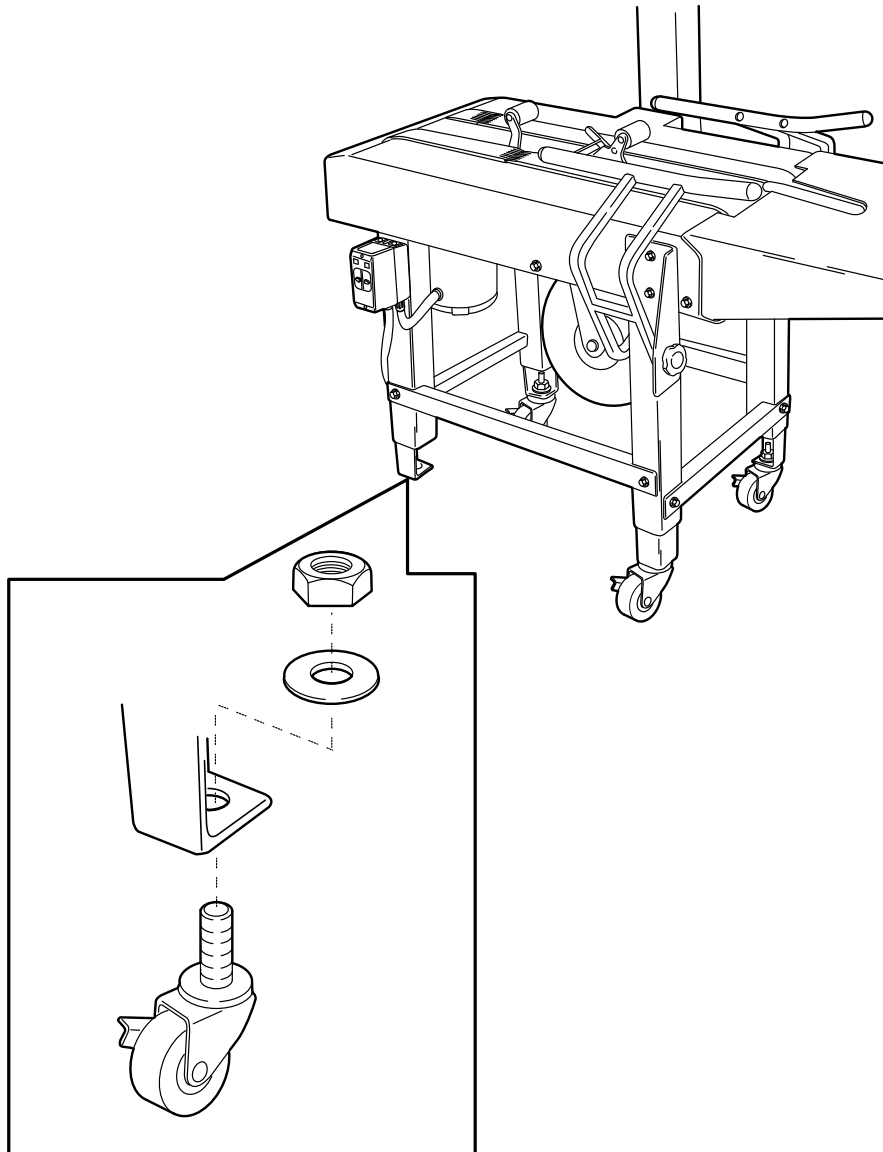

CAUTION! When raising the Case Taper off the floor to install the casters, use proper equipment to lift the case taper. Ensure the BB-2 SS Case Taper is secure and will not shift while the casters are being installed.

Set Machine Height

To adjust the leg height, loosen the screws shown on each leg. Slide the insert up or down to the required height, and then refasten the screws.

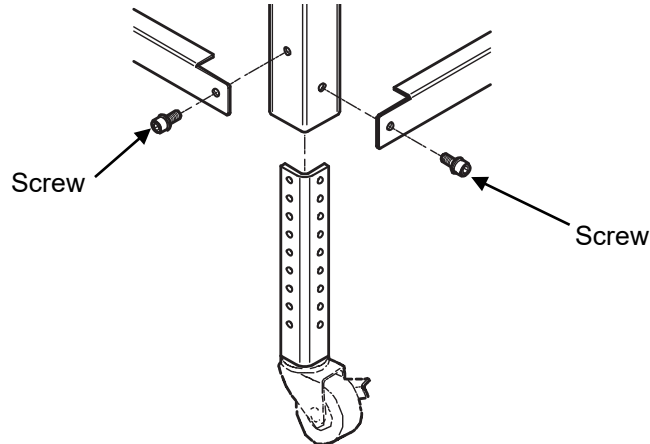

Location Requirements

To move the BB-2 SS to the desired location you will need to use a pallet jack or fork lift. If you have purchased the optional locking casters you can move the taper easily over a smooth flat surface.

When installing the BB-2 SS Taping System please be aware of the following considerations:

- The mounting surface is flat and level.
- Conveyor or packing table height.
- Alignment with packaging line.

When the BB-2 SS Taper is installed in the operating location you will need access to:

- The power switch.
- Height and width adjustments.
- Tape loading (Both upper and lower tape cartridges).

A packing table may be provided at the in-feed end where the packer can fill boxes and close the flaps prior to feeding the boxes into the machine. It is also convenient to have a pack table at the exit end of the taper.

It is essential that the table and conveyor be at the machine bed height.

The machine should be placed on a flat, level floor so that it does not rock or move. Optional locking casters are available to provide portability; however, we recommend that the machine be securely locked in place when used.

Loading the Tape Cartridges

Turn the main power off and disconnect power.

CAUTION! To avoid personal injury, remove the tape cartridge before loading tape.

When handling the tape cartridge be careful to avoid contact with the tape cutting blade.

Lower Cartridge

To remove the lower tape cartridge, it is necessary to raise the upper taping head by loosening the knob and raising the upper tape head to its highest upper position.

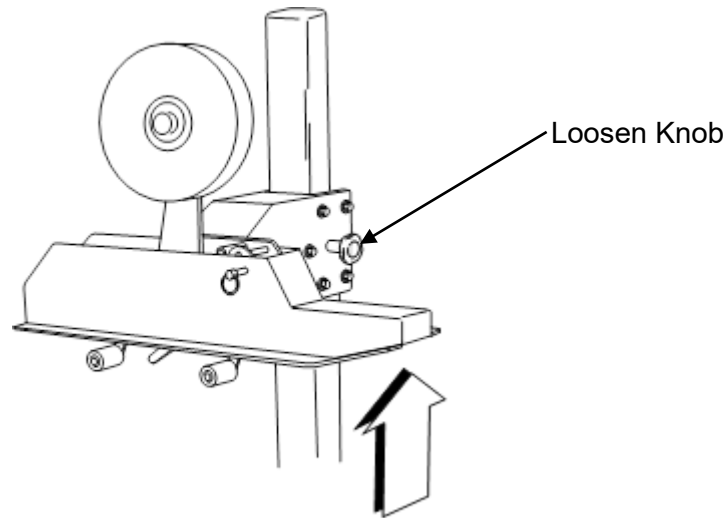

After raising the top tape head, remove the lower taping cartridge from the bottom section by holding both lift points and, lifting leading with the rear lift point first, raising the tape cartridge upward, out of the upper tape head seat.

CAUTION! Only lift the tape cartridge by the lift points indicated. Lift leading with the rear lift point first. Take care to keep away from any cutting edges.

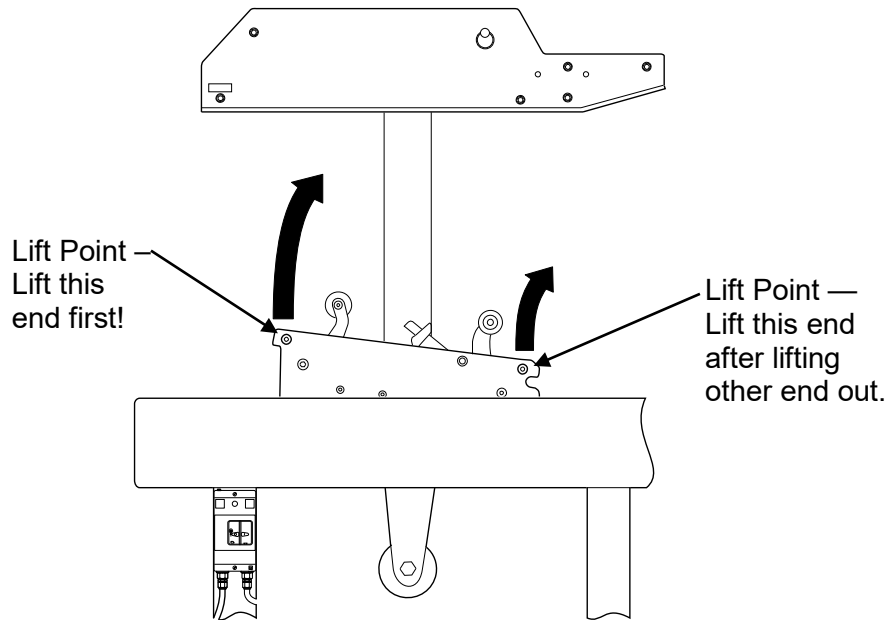

Prepare the Tape Roll

Push the tape roll onto the tape core assembly.

NOTE: Make sure the tape roll is pushed all the way on the tape core assembly.

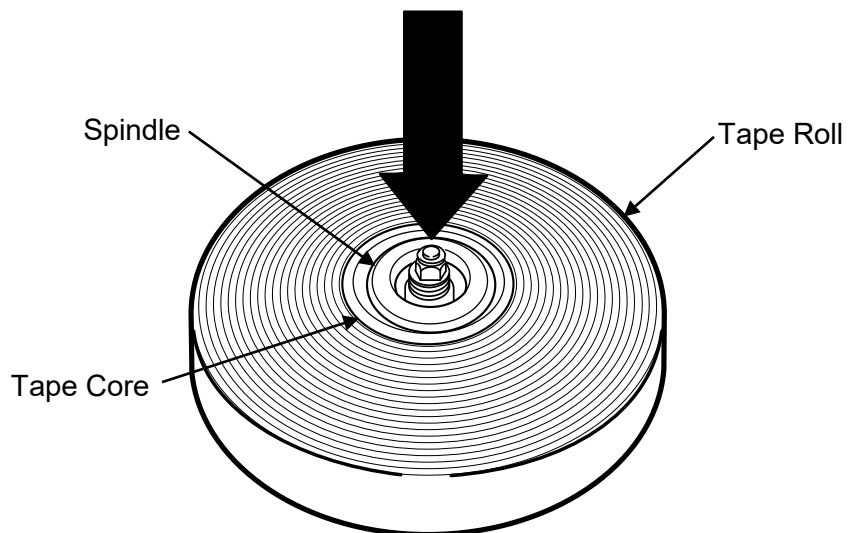

Check Tension

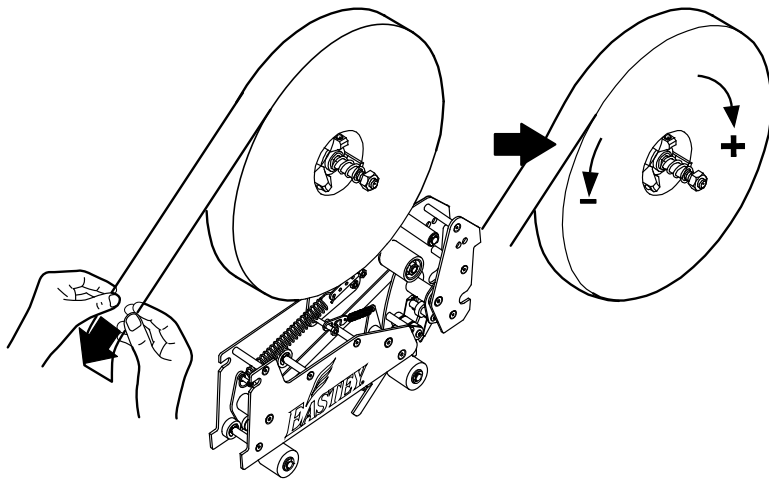

Check the tape for correct tension. If the tape head used with the taper allows for adjustment of tape tension, tighten or loosen the tape core holder to adjust to correct tension.

Thread Tape

Carefully thread the new tape through the rollers in the tape head as shown in the applicable diagram in the Tape Head User Guide provided with the tape head. Be careful to avoid the cutting edges.

For convenience, the diagram for threading tape in the EZ-EX Tape Head, which is the tape head normally offered with this machine, is provided on the following page. Follow the diagram that applies for your tape head, depending on the tape head model and position when installed in the taper.

EZ-EX Tape Head

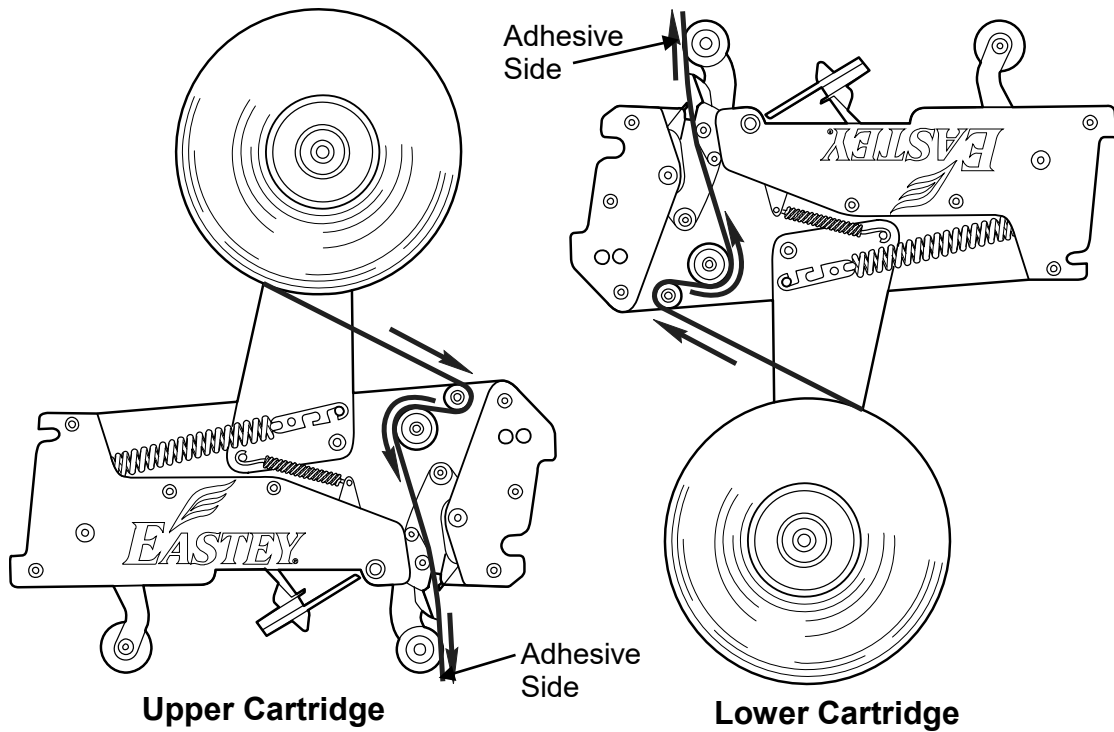

Reinstall the Lower Tape Cartridge

Supporting the lower tape head by the lift points indicated, lower the tape head into the machine.

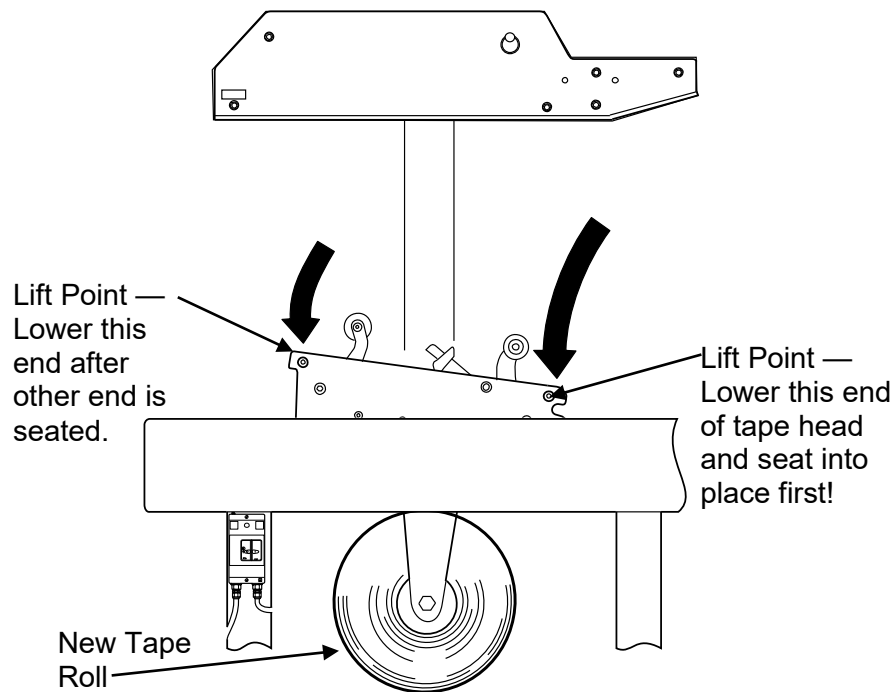

Upper Cartridge:

To remove the upper cartridge, it is helpful to lower the upper taping head to its lowest position. Pull the detent pin and raise the right end of the cartridge first.

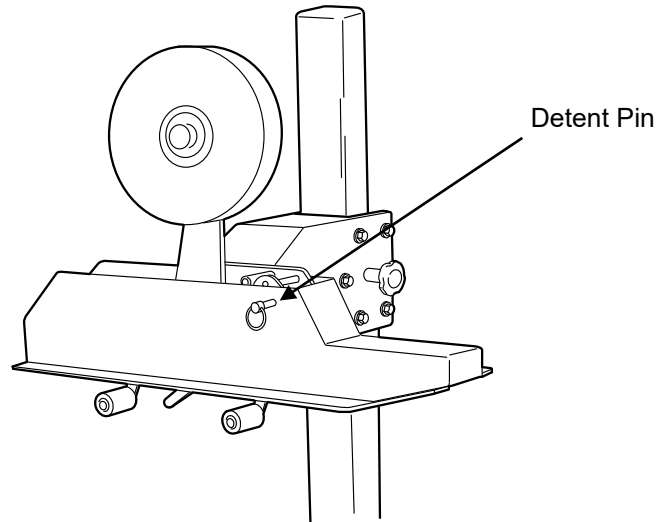

Lift the upper cartridge up and out of the machine.

CAUTION! Only lift the tape cartridge by the two lift points. Take care to keep away from any cutting edges.

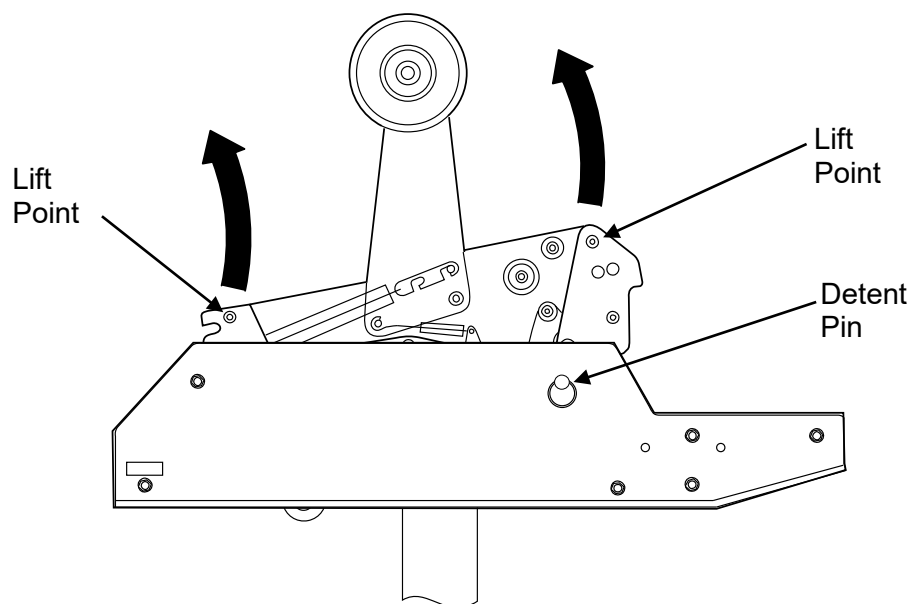

Thread Tape

Prepare the tape roll, check tape tension, and thread the tape through the rollers in the tape head for the upper tape cartridge following the same instructions provided for the lower tape cartridge.

Reinstall the Upper Tape Cartridge

Supporting the upper tape head by the lift points indicated, lower the tape head into the machine. Reinstall the detent pin to secure the upper tape head.

CAUTION! When replacing the upper tape cartridge only lift by the two lift points. Take care to keep away from any cutting edges.

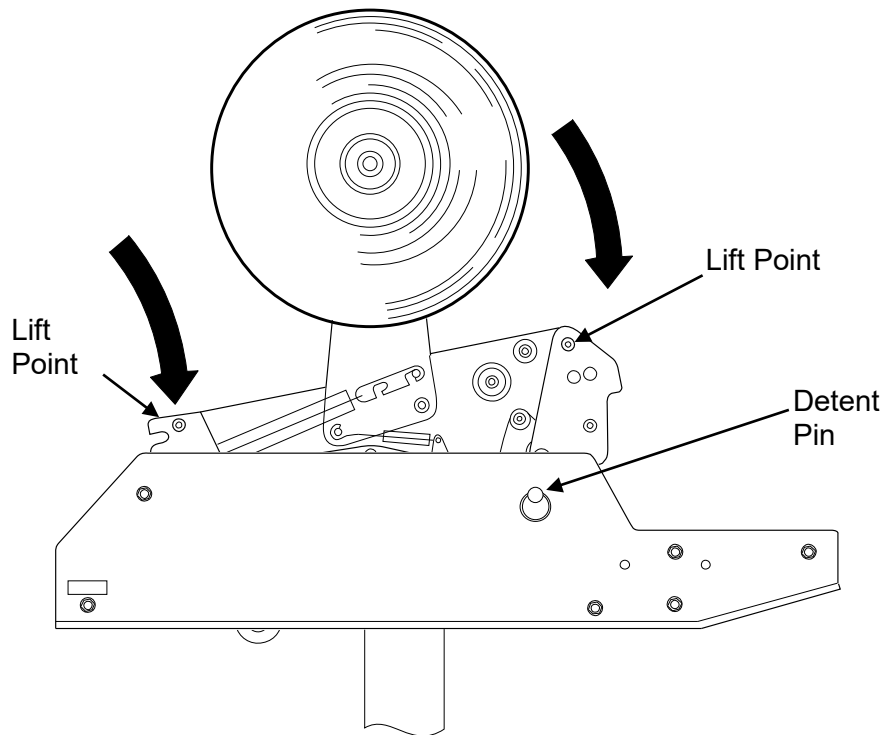

Operation

The BB-2 SS Industrial Case Taping System is very simple to operate. Before running the taper take a minute to double check your installation. Make sure the taper is at the correct height, is properly aligned with the packaging line and the package height and width adjustments are correct.

Plug the power cord into a properly wired and grounded receptacle.

Turn on the power switch.

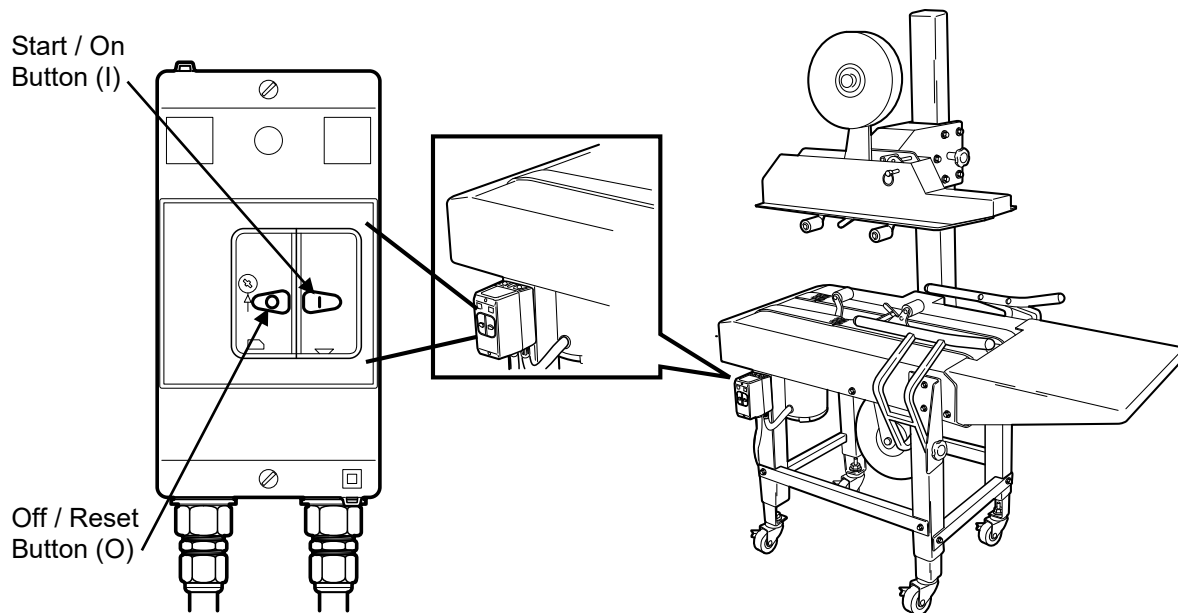

Run a package through the Taper.

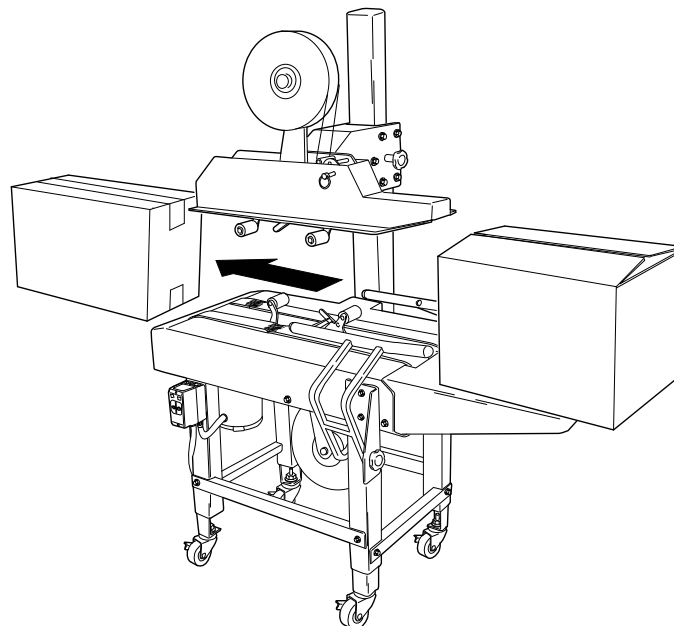

Adjustments

CAUTION! Make all adjustments with the machine turned off.

Package Width

Adjust width according to the box size.

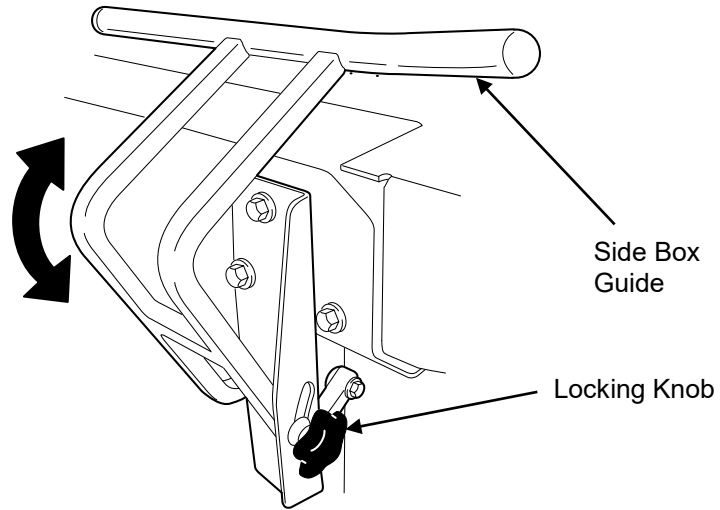

Package Height

Adjust height according to the box size.

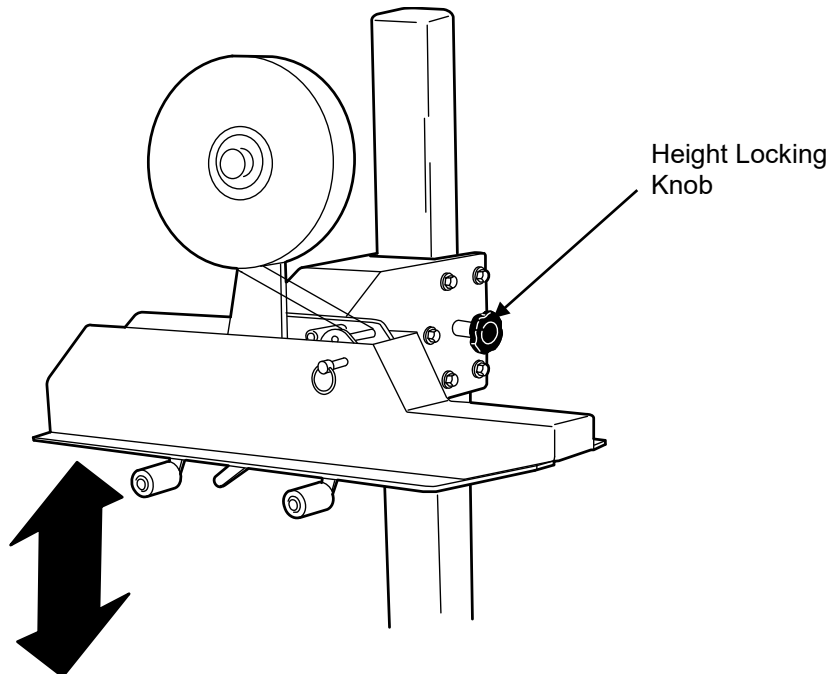

Maintenance

The BB-2 SS Industrial Case Taping System will provide many hours of maintenance free operation. There are a few items that may require attention from time to time.

Rollers

Make sure rollers stay clean and grease free. If you should have to clean the rollers simply wipe them down with a clean lint free cloth. If a more thorough cleaning is necessary wipe the rollers down with a mild detergent and water and let dry. **Never use harsh or abrasive cleaners or chemical agents when cleaning the rollers.**

Cutting Knives

Occasionally inspect the cutting knives to ensure they are clean and free of adhesive residue. Make sure the cutting knife is sharp by inspecting cuts in the tape. Cuts should be straight and neat. If the quality of cuts is eroding, the knife blade is dull and should be replaced.

Changing Knife Blades — Refer to Tape Head User Guide

Turn off and unplug the taper before inspecting or changing the knife blades. It is not necessary to remove either tape head to change the blade. Refer to the Tape Head User Guide provided with the tape head for instructions for changing the knife blades.

CAUTION! Always be aware of the cutting edges while replacing the knife blades. Handle the knife blades carefully.

Changing Drive Belts

Turn off and unplug the taper.

Grab the belt from underneath and firmly pull down until the idler arm drops into place and loosens the belt.

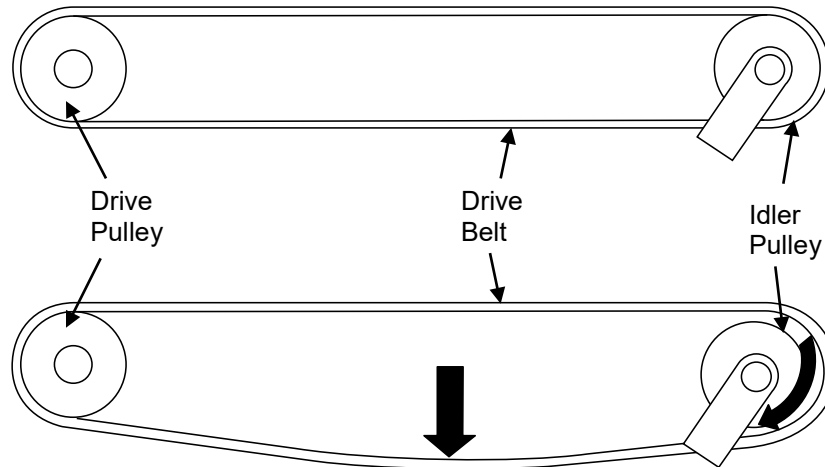

With the belt loose remove the copper connecting pin that holds the belt together.

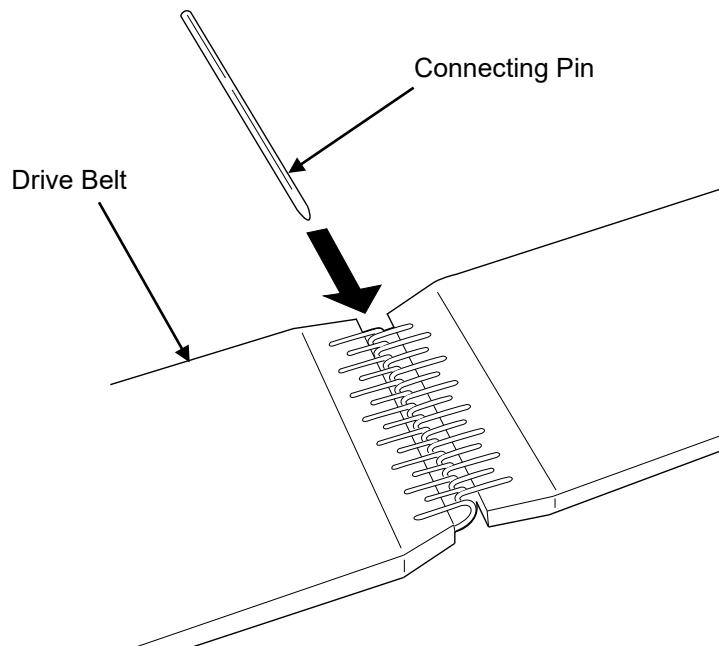

Take the belt off the machine.

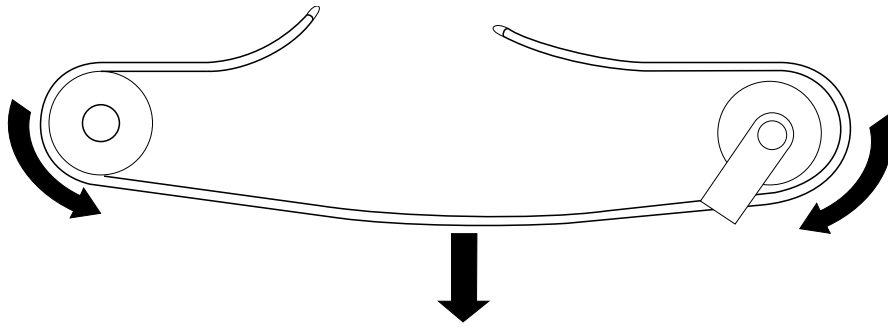

Install the new belt around the drive and idler pulleys.

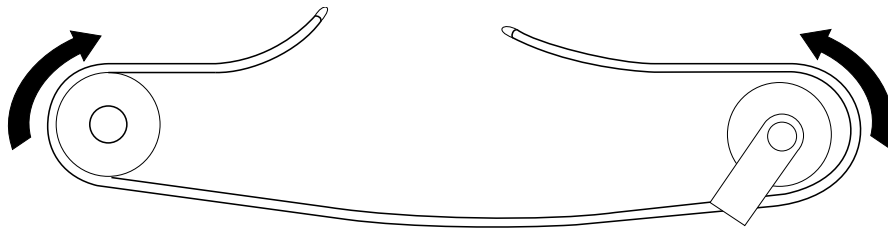

While the belt is still loose connect the ends by lining up the zipper and replacing the copper connecting pin.

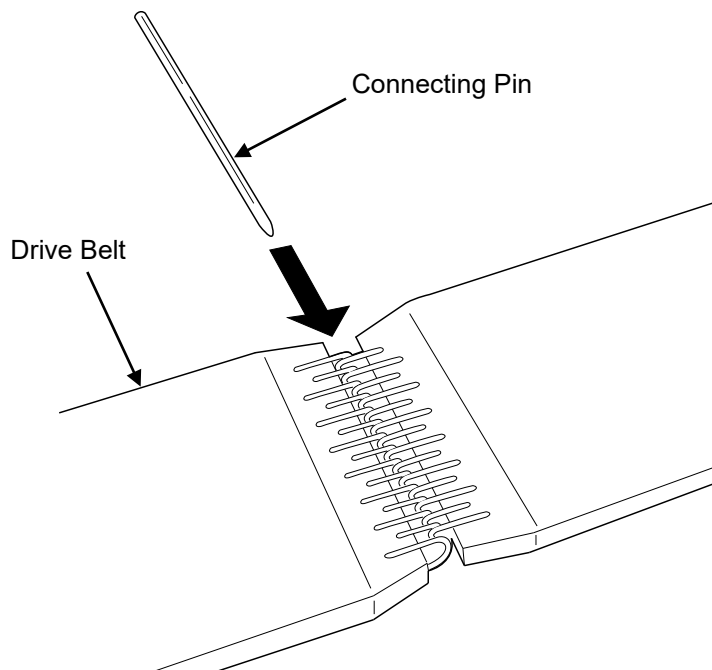

From underneath push the idler pulley back into the up position to tighten the belt.

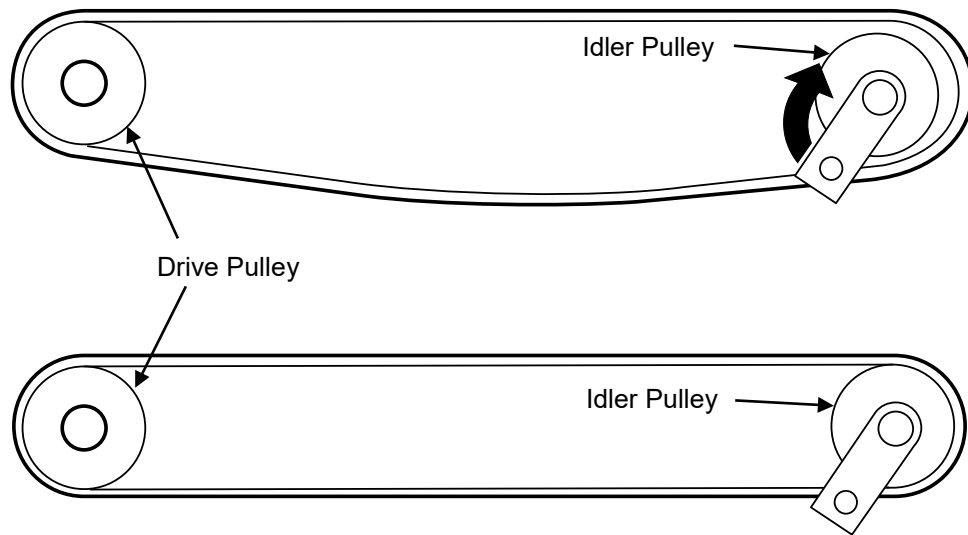

Plug in and turn on the BB-2 SS Case Taper to resume taping.

Troubleshooting

Problem	Solution
Taper will not start	<ul style="list-style-type: none"> • Check power input. • Circuit breaker has been tripped. <ul style="list-style-type: none"> - Check the amperage setting. - Reset the circuit breaker by pressing in on the Off/Reset button (O) and releasing it. <p>After resetting the circuit breaker, restart the machine by pressing the On/Start button (I).</p>
Machine is not operating	<ul style="list-style-type: none"> • Machine has inadequate electrical power or power is not connected. Verify system power meets specification requirements.
Stuck carton	<ul style="list-style-type: none"> • Check drive belt width adjustment. • Check for proper height adjustment.
Uneven or poor tape cuts	<ul style="list-style-type: none"> • Adjust knife arm spring tension. • Adjust wipe roller spring tension. • Replace cutting knives.
Uneven Tape Leg on Front	<ul style="list-style-type: none"> • Tape tension is incorrect. Increase tape tension.

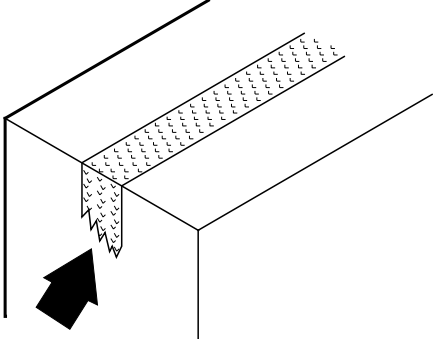
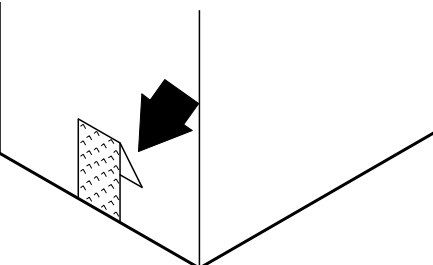
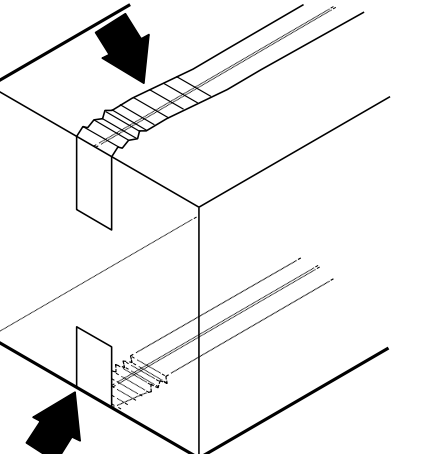
Problem	Solution
<p data-bbox="186 300 495 336">Uneven or Torn Tape</p> 	<ul data-bbox="678 304 1421 609" style="list-style-type: none"> • Blade is dull. Replace blade. • Tape tension is incorrect. Increase tension. • Clean and adjust blade. • Blade mounted incorrectly or backwards. • Knife arm spring is worn. Replace knife arm spring. • Adjust cartridge height.
<p data-bbox="186 724 381 760">Tape Folding</p> 	<ul data-bbox="678 724 1421 840" style="list-style-type: none"> • Check that all rollers turn freely. • Check to be sure tape is threaded properly on front roller.
<p data-bbox="186 1071 625 1106">Tape Curling and Bunching Up</p> 	<ul data-bbox="678 1071 1421 1228" style="list-style-type: none"> • Adjust the tape cartridge height (approximately .06 inches from box) • Check tape tension set by the spring tension at the tape core.

Parts List

Main Assembly

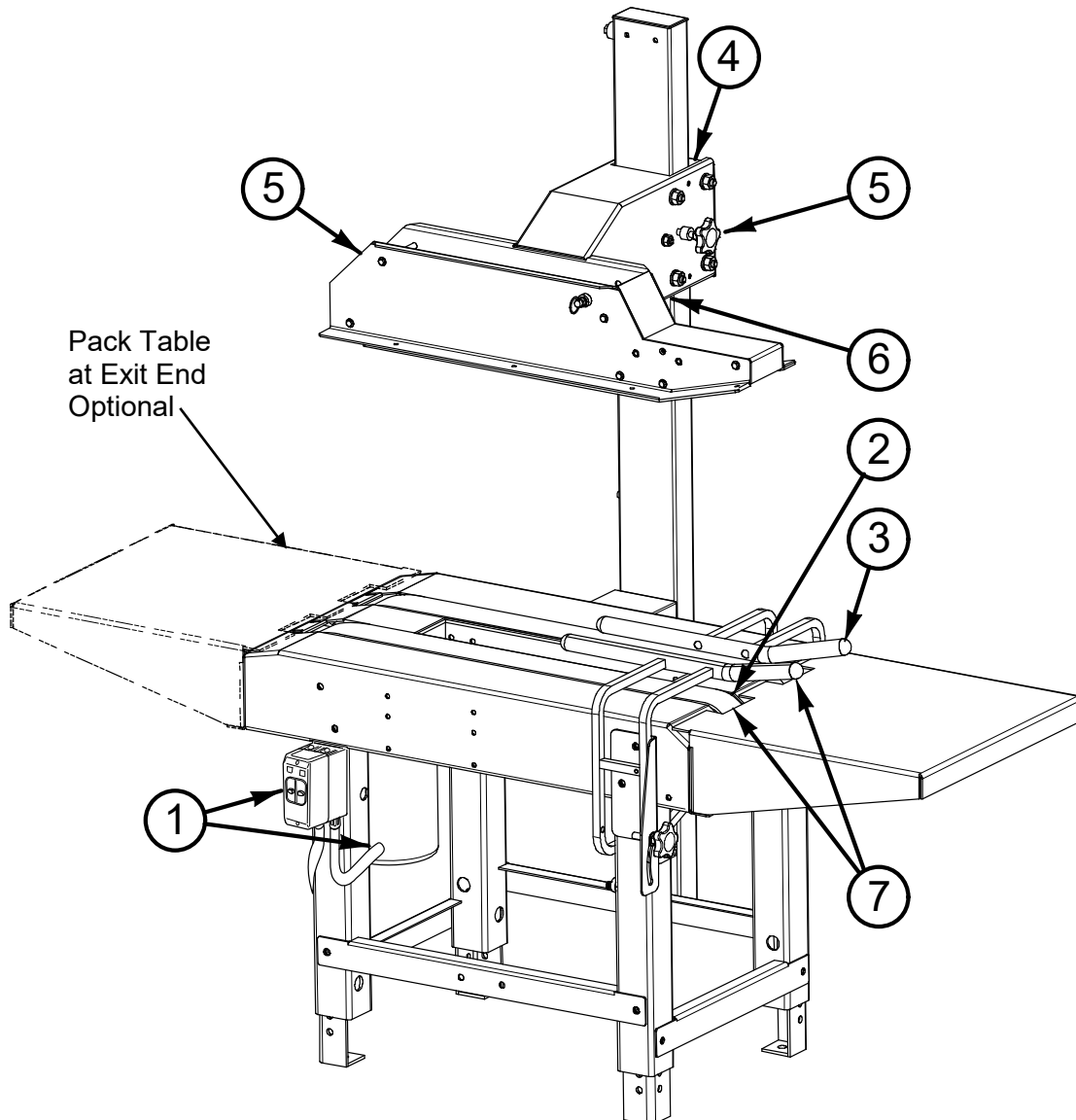

ITEM	DESCRIPTION	PAGE
1	ELECTRICAL / DRIVE MOTOR	28
2	INFEED / IDLER ROLLERS ASSEMBLY	29
3	CARTON GUIDES WITH WIDTH ADJUSTMENT	30
4	UPPER HEAD BRACKET BEARINGS	31
5	UPPER HEAD BRACKET AND HEIGHT LOCKING KNOB	32
6	UPPER HEAD CONSTANT FORCE SPRING ASSEMBLY	33
7	BELT (SET) – BOTTOM, BB2 LD3, 7, 15 (1 PAIR OF BELTS) — P/N 5000076	Q'TY 1

Electrical / Drive Motor

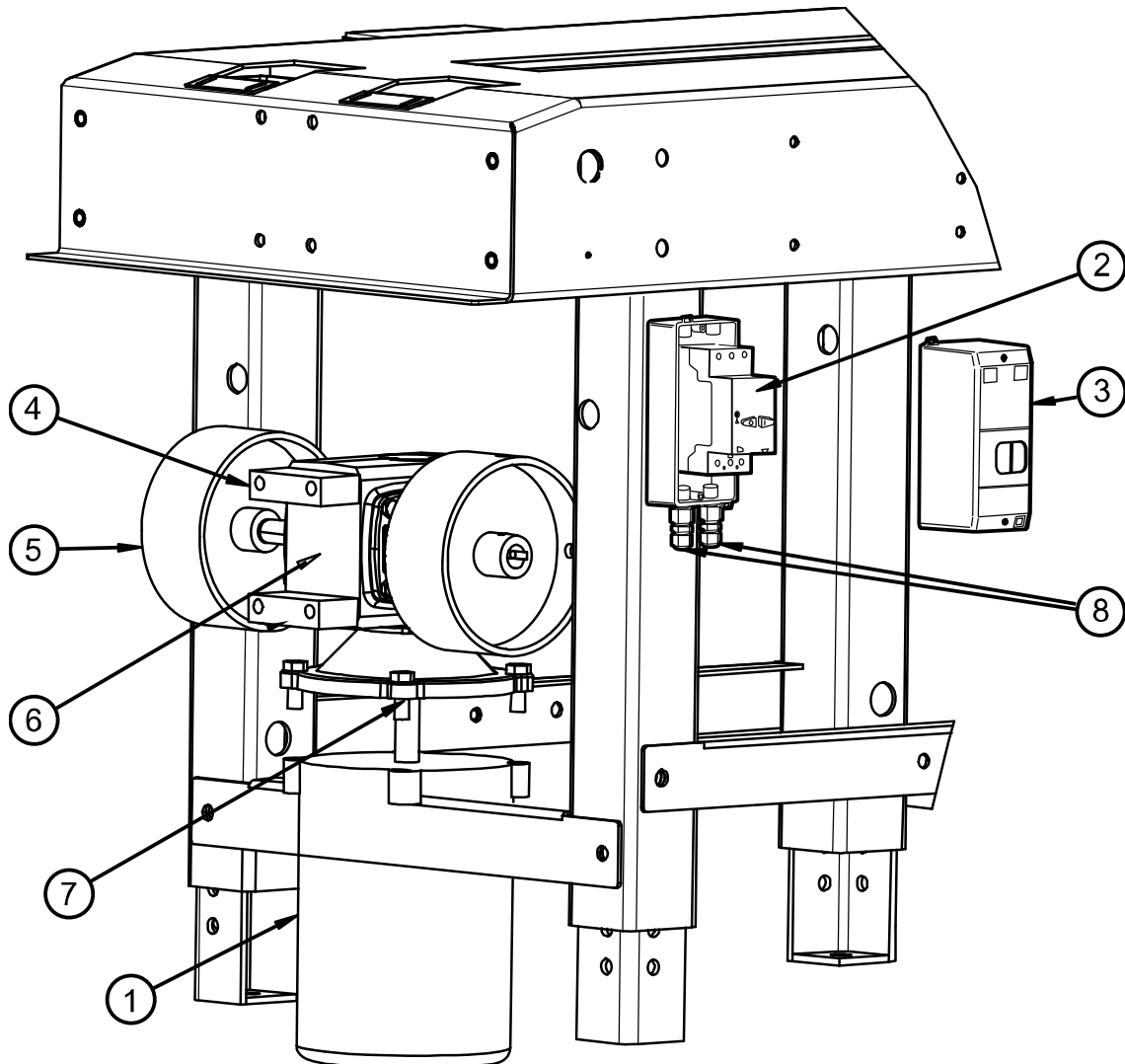

ITEM	PART NO.	DESCRIPTION	Q'TY
1	5001225	MOTOR – DRIVE, BB-2	1
2	5000041	SWITCH, SS – ON/OFF 120VAC	1
3	5000040	SWITCH ENCLOSURE	1
4	5000235	MACHINED SPACER REDUCER, REAR	2
5	5000845	FAB/WELD – DRIVE PULLEY BB	2
6	5000312	GEAR REDUCER	1
7	5000790	SCREW – HEX HEAD CAP 3/8-16 × 1 STAINLESS STEEL	4
8	1602053	CORD GRIPS ENCLOSURE	2

Infeed / Idler Rollers

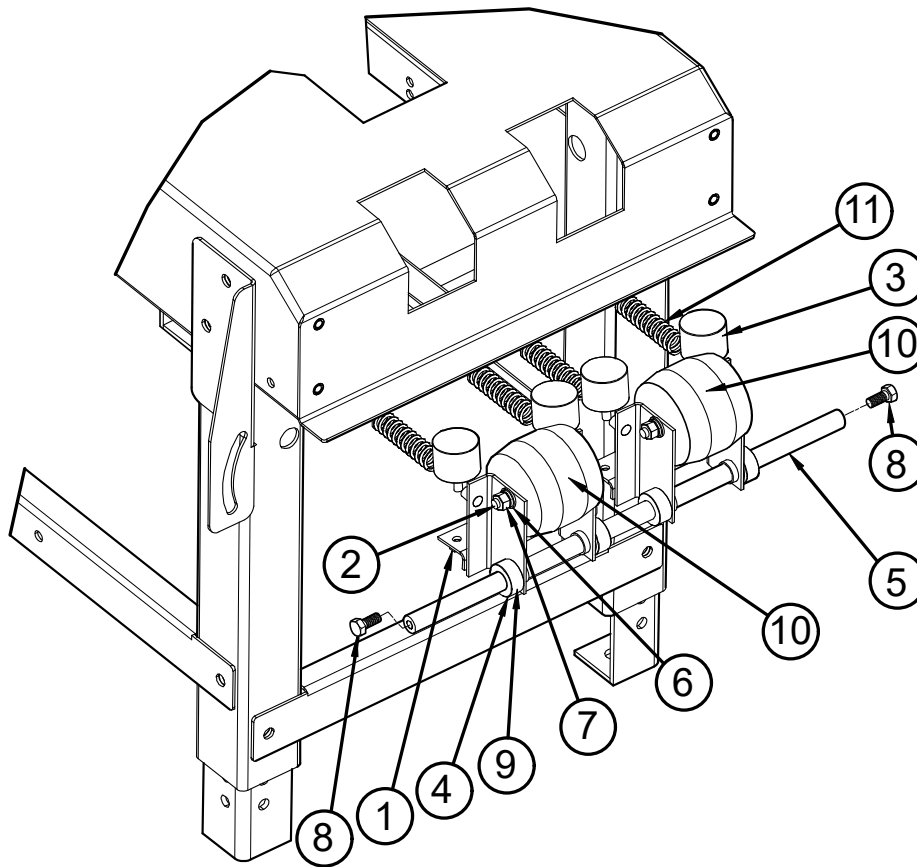

ITEM	PART NO.	DESCRIPTION	Q'TY
1	055307-047	NUT – HEX 1/4-20 STAINLESS STEEL	4
2	5001213	NUT – HEX, 5/16 -18 STAINLESS STEEL	2
3	5000043	ROLLERS – BELT GUIDE	4
4	5000051	COLLAR, SET SCREW, 5/8 NOM, STAINLESS STEEL	4
5	5000234	MACH – SHAFT – INFEED ROLLER, STAINLESS	1
6	055029-021	WASHER – FLAT 5/16, STAINLESS STEEL	6
7	5000669	SCREW – HHC 5/16-18 × 3-1/2, STAINLESS STEEL	2
8	055293-055	SCREW – HH 5/16-18 × 3/4 STAINLESS STEEL	2
9	5000826	BUSHING – PIVOT ARM	4
10	5000874	INFEED ROLLER	2
11	5010006	SPRING – COMPRESSION – STAINLESS STEEL	4

Carton Guides with Width Adjustment

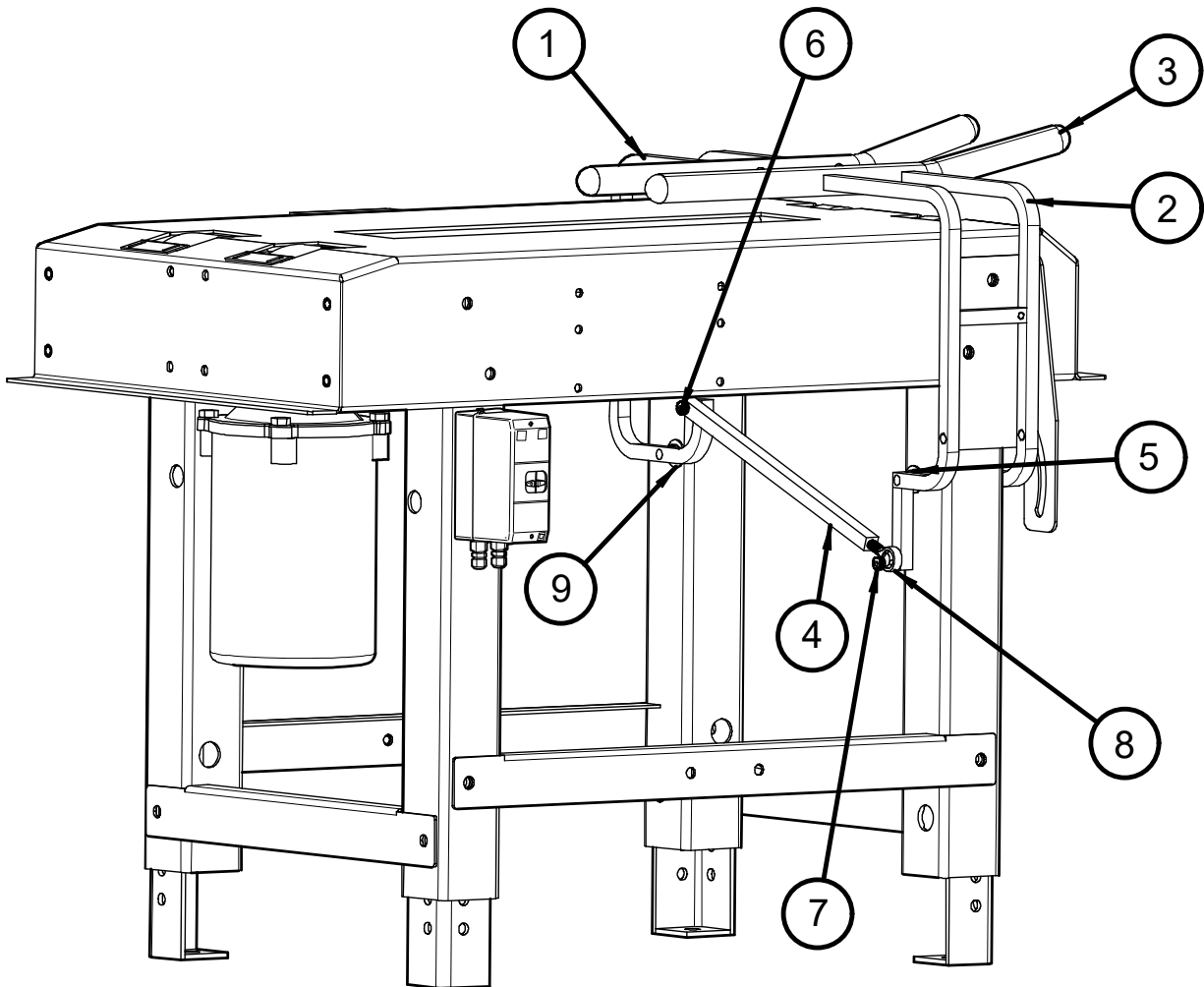

ITEM	PART NO.	DESCRIPTION	Q'TY
1	5000029	FAB/WELD – RAIL ARM, RIGHT, STAINLESS STEEL	1
2	5000031	FAB/WELD – RAIL ARM, LEFT, STAINLESS STEEL	1
3	5000033	END CAPS, SIDE RAIL	4
4	5000245	FAB – BB CONNECTING ARM, STAINLESS STEEL	1
5	5000247	MACH – SHAFT, SIDE RAIL PIVOT, STAINLESS	2
6	5000365	BOLT – SHOULDER ¼–20 × ½ STAINLESS STEEL	1
7	5000364	BOLT – SHOULDER ¼–20 × 5/8 STAINLESS STEEL	1
8	5000345	ROD END BEARING 5/16–24 STAINLESS STEEL	1
9	5000826	BUSHING – PIVOT ARM	4

Upper Head Bracket Bearings

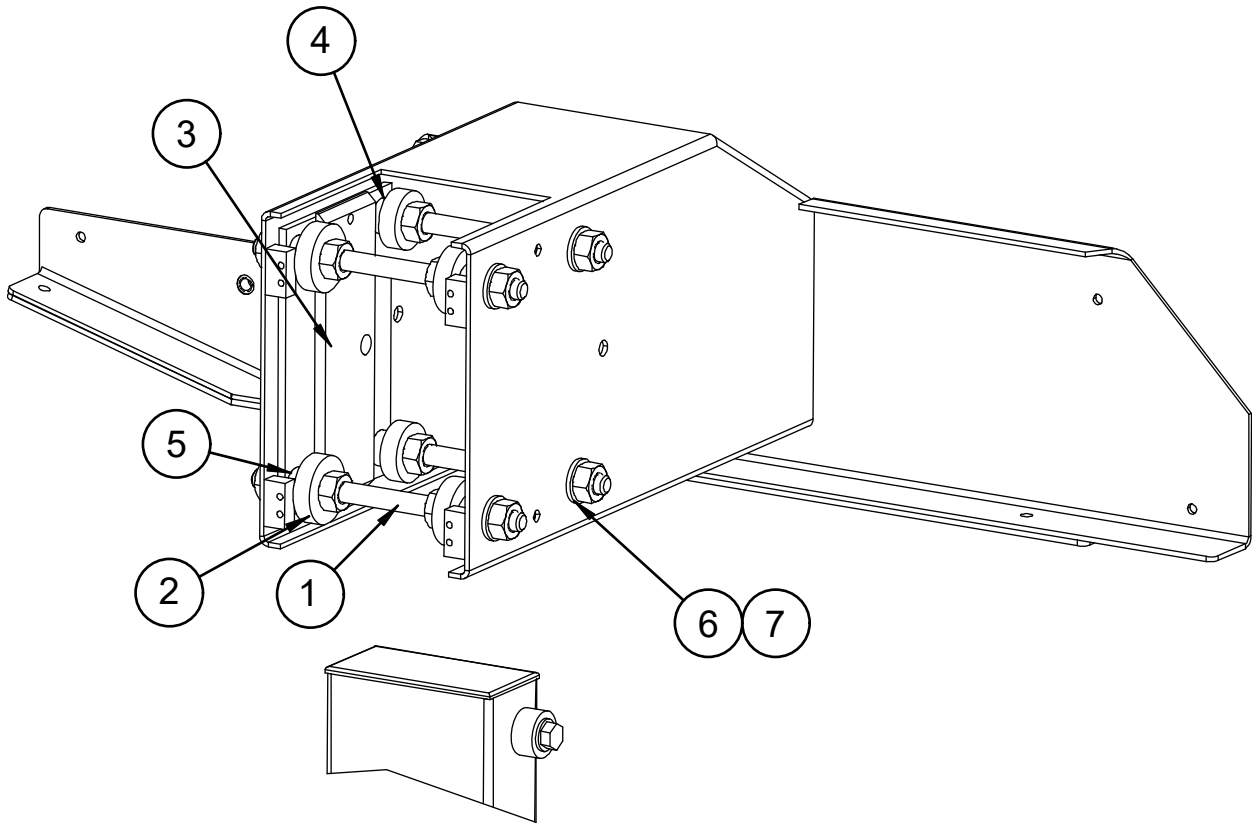

ITEM	PART NO.	DESCRIPTION	Q'TY
1	5000035	ROD – THREADED ROD, ½-13 × 6", STAINLESS	4
2	5000054	BEARING, BALL, STAINLESS STEEL	8
3	5000224	FAB – SLIDE 2	2
4	5000230	MACH – BEARING SPACER 5/16 STAINLESS STEEL	2
5	5000232	MACH – SPACER, BEARING 3/8 STAINLESS STEEL	6
6	1709026	WASHER, FLAT, ½" STAINLESS STEEL, AN960	8
7	2006041	NUT, HEX ½-13, STAINLESS STEEL	16

Upper Head Bracket and Height Locking Knob

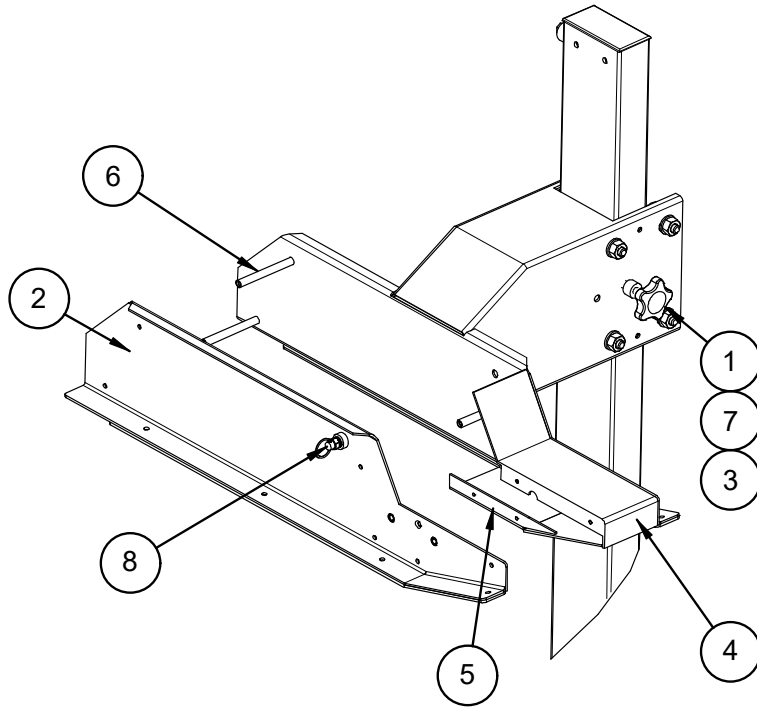

ITEM	PART NO.	DESCRIPTION	Q'TY
1	5000926	NUT, HEX 3/8-16, STAINLESS STEEL	1
2	5000011	WELD – HEAD, FRONT WELDMENT, STAINLESS	1
3	5000036	KNOB – HAND 2" DIA.	1
4	5000216	FAB – COVER PLATE, STAINLESS STEEL	1
5	5000218	FAB – FILL IN PLATE, STAINLESS STEEL	1
6	5000228	MACH – SPACER, HEAD PLATES, STAINLESS	3
7	5000352	ROD – THREADED, 3/8-16 × 2-3/4"	1
8	5000595	PLUNGER – RETRACTABLE, STAINLESS STEEL	1

Upper Head Constant Force Spring Assembly

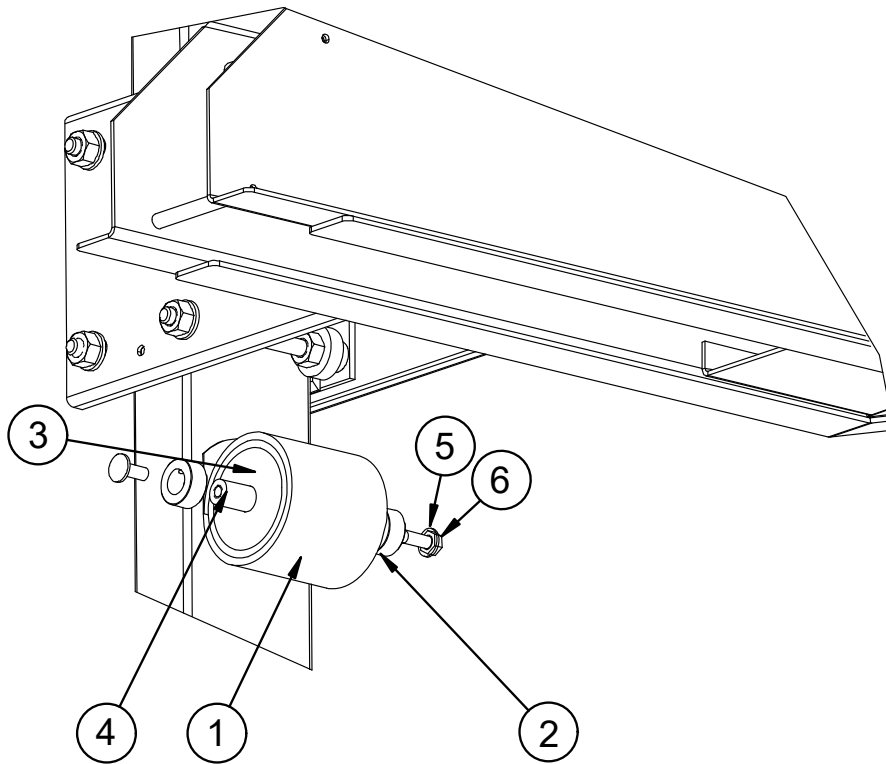

ITEM	PART NO.	DESCRIPTION	Q'TY
1	5000046	SPRING – CONSTANT FORCE 3" WIDE	1
2	5000051	COLLAR, SET SCREW, 5/8" NOMINAL, STAINLESS	2
3	5000202	MACH – DRUM, CONSTANT FORCE SPRING	1
4	5000213	MACH – SHAFT, DRUM STAINLESS STEEL	1
5	055029-021	WASHER – FLAT 5/16, STAINLESS STEEL	2
6	055293-055	SCREW – HEX HEAD 5/16-18 × 3/4 STAINLESS	2

Tape Head — Refer to Tape Head User Guide

Refer to the parts illustrations and listings in the Tape Head User Guide provided with the tape head for identification and part numbers of tape head parts.

Warranty Statement

BB-2 SS Industrial Case Taping System

Warranty Statement

Eastey warrants that all of the products it ships will be in good working order and free from defects in material and workmanship and will conform to the published specifications for that product.

Warranty Period

Drive motor(s): 1 year
Gear reducer: 1 year
Tape head: 1 year (Except for moving parts which are subject to normal wear, tear and replacement which are warranted to be free from defects in material and workmanship.)

All other parts: 1 year (Except for moving parts which are subject to normal wear, tear and replacement which are warranted to be free from defects in material and workmanship.)

Taping Quality

Taping quality achieved in a given application is dependent on the installation, the material handling, and the maintenance provided. Eastey makes no warranty that the taping quality achieved in an application will be the same as that achieved on a test piece in our demo facility.

Shipping Policy

Customer pays all incoming shipping. If the item is defective and under warranty, Eastey pays return shipping charges for least costly method. If expedited shipping is desired, customer must furnish his shipping account and shipping fees will be charged to that account.

Warranty Verification

If you conclude that a product may be defective and may be covered by warranty, obtain a Return Material Authorization number by calling our technical support number (toll free at 1-800-835-9344, or 763-428-4846 or Fax: 763-795-8867) or e-mail: info@eastey.com, and return the defective item to Eastey. Eastey will analyze the product and, if found to be defective, we will, at our option, replace or repair the item. If the item is found to not be eligible for warranty, you will be notified and may decide on disposition. Defective products will be replaced or repaired as promptly as possible.

Warranty Eligibility

The warranty provided by Eastey is only to the original buyer.

Limited Warranty

THE ABOVE WARRANTY IS EXCLUSIVE AND IN LIEU OF ALL OTHER WARRANTIES, WHETHER EXPRESSED OR IMPLIED, INCLUDING THE IMPLIED WARRANTIES OF MERCHANTABILITY, FITNESS FOR A PARTICULAR PURPOSE AND NONINFRINGEMENT.

Disclaimer of Damages

REGARDLESS OF WHETHER ANY REMEDY SET FORTH HEREIN FAILS OF ITS ESSENTIAL PURPOSE, IN NO EVENT WILL EASTEY BE LIABLE FOR ANY SPECIAL, CONSEQUENTIAL, INDIRECT OR SIMILAR DAMAGES, INCLUDING LOST PROFIT OR LOST OPPORTUNITIES OF ANY TYPE ARISING OUT OF THE USE OR INABILITY TO USE THESE PRODUCTS EVEN IF EASTEY HAS BEEN ADVISED OF THE POSSIBILITY OF SUCH DAMAGES.

Customer Support

Eastey Technical Service

For help setting up or operating the BB-2 SS Case Taper, please contact Eastey Technical Service at one of the numbers listed below.

Toll-Free Phone	800-835-9344
Phone	763-428-4846
Fax	763-795-8867
E-mail	info@eastey.com
Web	www.eastey.com

Thanks again for your purchase of Eastey products. We are pleased to be a part of your packaging needs.



EASTEY®